

McKATTM

Lifting Beyond Boundaries



INTRODUCTION

The complete range of McKAT lifting equipment stands for your safety as first priority. Our superior quality of raw material is carefully chosen resulting in lifting accessories that are consistent and reliable. Each lifting accessory unit undergoes a strict inspection and testing process as per international standards and norms giving our customers worldwide the best choice to work with in a safe environment.

Quality and Safety of all lifting materials and handling products are fully tested and certified before despatch: we only supply proven robust products that give you reliability and a long life.

Proactive product development, our product range is always evolving to meet the ever changing needs of our customers, our aim is to introduce new innovative equipment and insure our prices remain competitive without compromising safety.

Spare parts, we hold extensive stocks of spare parts which keeps your down time to minimum.

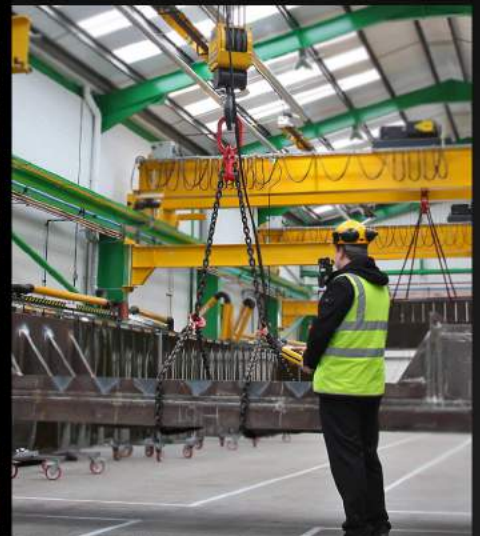

139, Fulton Street, Suite 902, New York, NY - 10038

 (212) 571 - 1770.  (212) 571 - 1771

 sales@mckat.us

 www.mckat.us

PRODUCT RANGE

- Chain Block
- Lever Hoist
- Beam Clamp
- Plain Trolley
- Gear Trolley
- Wire Rope Winch
- Ratchet Load Binder
- Lever Load Binder
- Bow Shackles
- D Shackles
- Chain Slings
- Master Link
- Master Link Assembly
- G80 - Chain
- Clevis Chain Clutch
- Connecting Link
- Webbing Connecting Link
- Clevis Sling Hook
- Eye - Sling Hook
- Clevis Self Lock Hook
- Eye - Self Lock Hook
- Grab Hook
- Pipe Sorting Hook
- Container Lugs
- Large Opening Container Hook
- Weld On Clamp
- Forged D Ring
- Heavy Duty Thimble
- Barrel Clamp



McKAT[®]

CHAIN BLOCK



Heavy Duty Chain Guide Roller



Heavy Duty Slack Chain Anchorage



Precision Forged Chain Cover



Moving Products



Uprooting Tree



Installing Underwater



Laying Pipelines

DESCRIPTION

- Compacted design & light weight.
- Heat treated body, shaft & gears.
- Precised forged high strength chain cover that prevent the outside dust and outside impact.
- Forged lifting and suspension hooks, with safety latches.
- T80 High strength load chain, high safety factor, long service life.
- Steady rotation, High efficiency, light hand pulling force.
- Heavy duty guide roller and chain seperator to ensure easy performance.
- Heavy duty chain slack anchorage which is tested to 2.5 times of the WLL.
- Comes with international style of packaging.
- Spares are available for suspension hook latch kit and friction disc.

Standard:	BS EN 13157: 2004
Material:	Forged Alloy Steel
FOS:	4:1
Heat Treatment:	Quenched & tempered
Proof Load:	1.5 WLL

MCKAT CHAIN BLOCK SPECIFICATION:

MODEL NO.	WLL (T)	HEIGHT OF LIFT (m)	HEADROOM (mm)	LOAD CHAIN SIZE (DIA X Pitch) (mm)	FALLS (mm)	PULL EFFORT (kg)	NET WT. (kg)
CB-500	0.5	3	310	5x15	1	35	10
CB-1000	1	3	350	6x18	1	33	12
CB-1500	1.5	3	365	8x24	1	35	17
CB-2000	2	3	490	8x24	1	37	20
CB-3000	3	3	510	8x24	2	36	24
CB-5000	5	3	670	10x30	2	41	42
CB-10000	10	6	805	10x30	4	41	140
CB-15000	15	6	895	10x30	6	44	165
CB-20000	20	6	990	10x30	8	60	252
CB-30000	30	6	1090	10x30	12	66	300

*STAR FEATURE: The Height of Lift (HOL) of MckAT Chain Blocks can be customized according to the requirements.

McKAT[®]

LEVER HOIST



Heavy Duty Chain Guide Roller



Chain Spooling Free Wheel



Precision Forged Chain Cover



Lifting



Lowering



Fastening



Pulling

DESCRIPTION

- ▶ Compacted design & light weight.
- ▶ Heat treated body, shaft & gears.
- ▶ Precised forged high strength chain cover that prevent the outside dust and outside impact.
- ▶ Forged lifting and suspension hooks, with safety latches.
- ▶ T80 High strength load chain, high safety factor, long service life.
- ▶ Heavy duty guide roller and chain seperator to ensure easy performance.
- ▶ Heavy duty chain slack anchorage which is tested to 2.5 times of the WLL.
- ▶ Comes with international style of packaging.
- ▶ Spares are available for suspension hook latch kit and friction disc.

Standard:	BS EN 13157: 2004
Material:	Forged Alloy Steel
FOS:	4:1
Heat Treatment:	Quenched & tempered
Proof Load:	1.5 WLL

MCKAT LEVER HOIST SPECIFICATION:

MODEL NO.	WLL (T)	HEIGHT OF LIFT (mm)	HEADROOM (mm)	LOAD CHAIN SIZE (DIA X Pitch) (mm)	FALLS (mm)	PULL EFFORT (kg)	NET WT. (kg)
LH-750	0.75	1.5	320	6x18	1	14	7
LH-1000	1	1.5	335	8x24	1	14	9
LH-1500	1.5	1.5	350	10x30	1	24	11
LH-3000	3	1.5	490	10x30	1	32	17
LH-6000	6	3	649	10x30	2	34	27
LH-9000	9	3	750	10x30	2	36	47

*STAR FEATURE: The Height of Lift (HOL) of MckAT Lever Hoist can be customized according to the requirements.

McKAT

BEAM CLAMP



DESCRIPTION

- ▶ Lightweight portable design.
- ▶ Jaw opening adjusts for wide range of tapered or flat-flanged beams.
- ▶ Provide shackle suspender for oversized hooks.
- ▶ Beam Clamp is individually tested and inspected with proof load.



Standard:	BS EN 13157: 2004
Material:	Forged Alloy Steel
FOS:	4:1
Heat Treatment:	Quenched & tempered
Proof Load:	1.5 WLL

DIAGRAM:

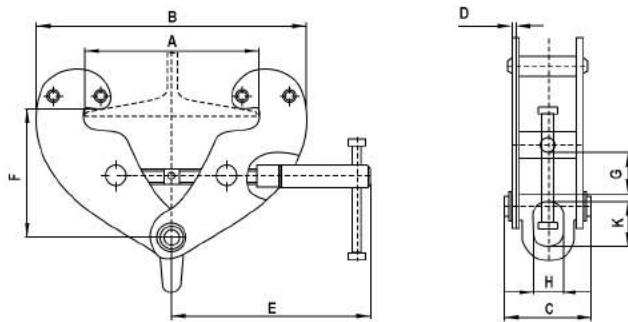

MCKAT BEAM CLAMP SPECIFICATION:

MODEL NO.	Rated Capacity (T)	Adjustable Beam Width (mm)	Dimensions (mm)											NET WT. (kg)	
			A		B		C	D	E	F		G	H		K
			Max.	Min.	Max.	Min.				Max.					
MBC-1000	1	75-230	240	192	367	94	4	218	103	155	20	30	45	4.2	
MBC-2000	2	75-230	240	192	367	102	6	218	103	155	20	30	45	5.1	
MBC-3000	3	80-320	330	243	491	132	8	258	157	223	47	45	63	10.4	
MBC-5000	5	80-320	330	243	491	142	10	258	157	223	47	45	47	12.2	
MBC-10000	10	90-320	330	259	501	180	12	293	175	235	56	64	95	18.8	

McKAT

PLAIN TROLLEY



DESCRIPTION

- Rugged steel side plates formed to include bumpers and trolley guards.
- Equipped with specially designed contoured wheels that fit both tapered and flat-flanged beams.
- Maintenance-free, sealed precision ball bearings that offer smooth movement, with low friction and long life.
- High strength and rigidity with lightweight and compact design.
- Easily adjust trolley to fit a wide variety of beam flange width.
- To be used with hook suspended hoist.

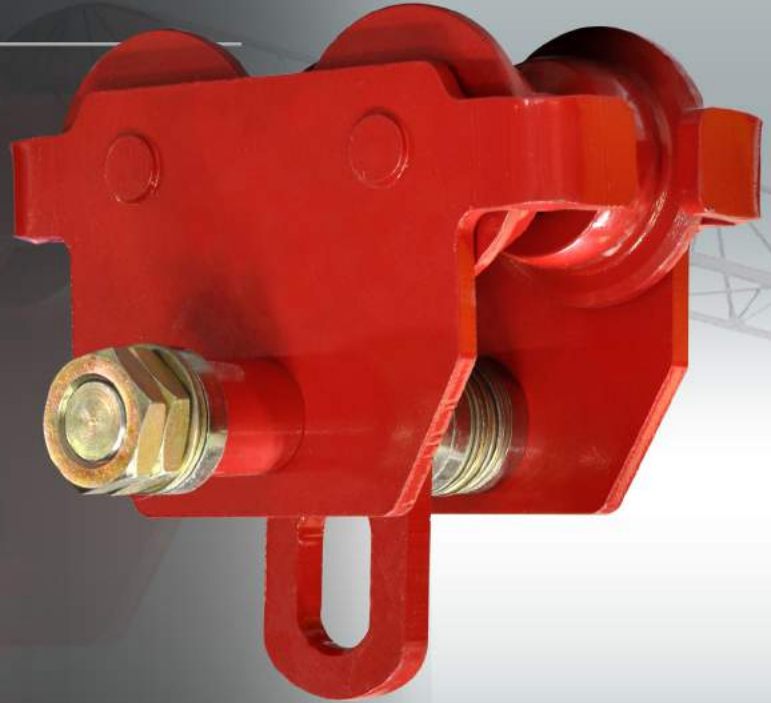

Standard:	BS EN 13157: 2004
Material:	Forged Alloy Steel
FOS:	4:1
Heat Treatment:	Quenched & tempered
Proof Load:	1.5 WLL

DIAGRAM:

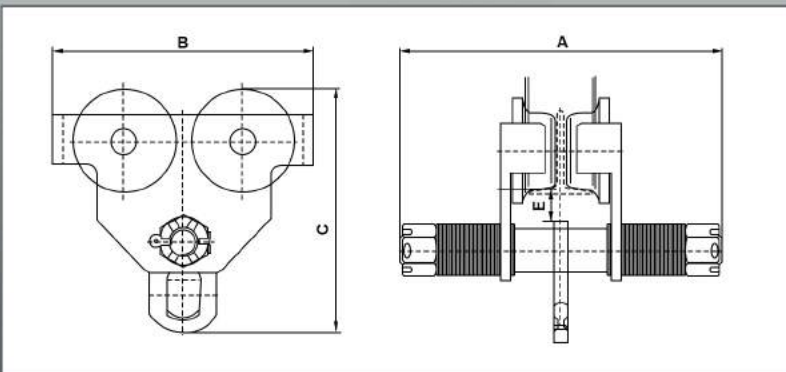

MCKAT PLAIN TROLLEY SPECIFICATION:

MODEL NO.	Rated Capacity	Min. Radius of Curve (m)	Dimensions (mm)				Adjustable Beam Width (mm)	NET WT. (kg)
			A	B	C	E	M	
MPT-500	0.5	0.9	264	216	195	31	64-152	8.6
MPT-1000	1	1	335	260	239	32.5	64-203	15.4
MPT-2000	2	1.1	353	300	286	31	88-203	23
MPT-3000	3	1.3	371	325	336	35	102-203	40
MPT-5000	5	1.4	393	390	393	37	114-203	50
MPT-10000	10	1.7	436	470	500	45	125-203	97

McKAT[®]

GEAR TROLLEY



DESCRIPTION

- ▶ Rugged steel side plates formed to include bumpers and trolley guards.
- ▶ Equipped with specially designed contoured wheels that fit both tapered and flat-flanged beams.
- ▶ Equipped with hand chain and gear for moving heavier load easily.
- ▶ Maintenance-free, sealed precision ball bearings that offer smooth movement, with low friction and long life.
- ▶ High strength and rigidity with lightweight and compact design.
- ▶ Easily adjust trolley to fit a wide variety of beam flange width.
- ▶ To be used with hook suspended hoist.



Standard: BS EN 13157: 2004
Material: Forged Alloy Steel
FOS: 4:1
Heat Treatment: Quenched & tempered
Proof Load: 1.5 WLL

DIAGRAM:

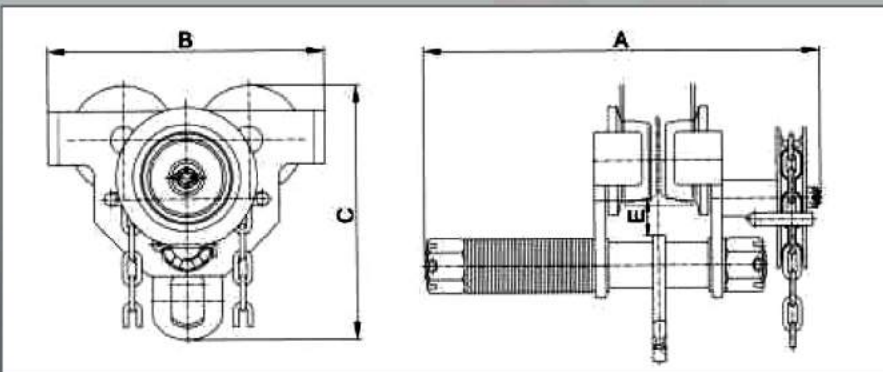

MCKAT GEAR TROLLEY SPECIFICATION:

MODEL NO.	Rated Capacity	Min. Radius of Curve (m)	Dimensions (mm)				Adjustable Beam Width (mm)	NET WT. (kg)
			A	B	C	E	M	
MGT-1000	1	1	390	260	239	32.5	64-203	19.9
MGT-2000	2	1.1	400	300	288	31	88-203	28.5
MGT-3000	3	1.3	430	345	336	35	102-203	46
MGT-5000	5	1.4	444	390	393	37	114-203	57
MGT-10000	10	1.7	489	470	500	45	125-203	103

McKAT

WIRE ROPE WINCH



DESCRIPTION

- ▶ Compacted design & light weight.
- ▶ High strength cast aluminum body.
- ▶ Adjustable handle for easy operation
- ▶ Galvanised steel wire rope mounted on a reel
- ▶ Built-in shearing pin to prevent over load



Standard:	BS EN 13157: 2004
Material:	Forged Alloy Steel
FOS:	4:1
Heat Treatment:	Quenched & tempered
Proof Load:	1.5 WLL

DIAGRAM:

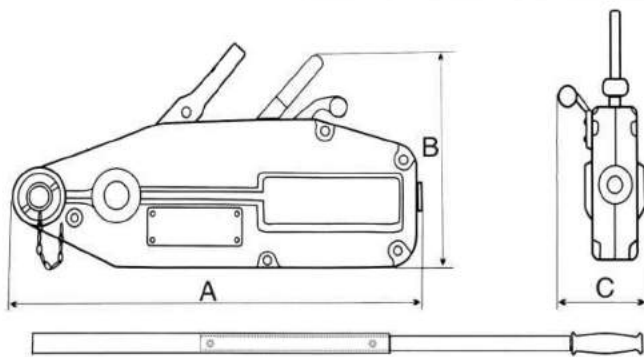

MCKAT WIRE ROPE WINCH SPECIFICATION:

MODEL NO.	Rated Capacity (T)	Pulling Capacity (T)	Efficient Length of forward handle (mm)	Drive Step	Rope Diameter (mm)	Standard Length of Rope (m)	NET WT. (kg)	Rated forward hand power (kg)	Max. Overall Size (mm)
MTW-800	0.8	1.2	825	1	8	20	16	≤284	428x64x235
MTW-1000	1.0	1.5	825	1	8	20	16	≤353	428x64x235
MTW-16000	1.6	2.4	1200	1	11	20	24	≤412	545x97x286
MTW-32000	3.2	4.8	1200	2	16	20	48	≤441	660x116x350

McKAT

LEVER LOAD BINDER



DESCRIPTION

- ▶ Design for heavy duty transport use.
- ▶ Equipped with heavy duty grab hooks.
- ▶ Heavier construction.
- ▶ Powder coated finish.
- ▶ Embossed forged marking for WLL, SIZE, CE and McKAT

Standard: BS EN 12195-3
Material: Body - Forged carbon steel, Hooks - Alloy Steel
FOS: 3.5:1
Heat Treatment: Quenched & tempered
Proof Load: At 200 % of WLL
Colour Code: Red



MCKAT LEVER LOAD BINDER DIAGRAM:

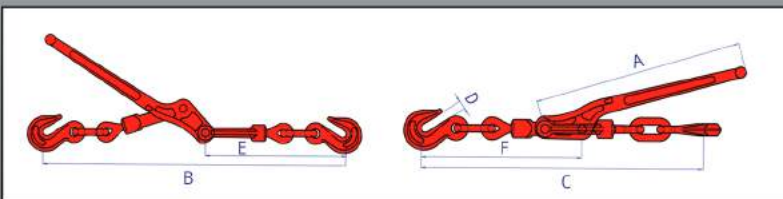

Car Lashing



Pipe Lashing

MCKAT LEVER LOAD BINDER SPECIFICATION:

Model no.	Min - Max Chain Size (mm)	WLL (kgs)	WEIGHT (kgs)	HANDLE LENGTH (mm)	TAKE UP (mm)	DIMENSIONS (mm)					
						A	B	C	D	E	F
MVL-01	06mm	1,000	1.65	306	75	306	440	365	10	215	209
MVL-02	8mm-10mm	2,400	3.60	400	104	400	607	503	12.7	264	285
MVL-04	10mm-13mm	4,200	5.70	440	130	440	695	565	16.5	312	324
MVL-06	13mm-16mm	6,000	9.20	517	153	517	848	695	18.5	371	391

McKAT

RATCHET LOAD BINDER



DESCRIPTION

- ▶ Design for heavy duty transport use.
- ▶ Equipped with heavy duty grab hooks.
- ▶ Heavier construction.
- ▶ Powder coated finish.
- ▶ Embossed forged marking for WLL, SIZE, CE and McKAT

Standard: BS EN 12195-3
Material: Body - Forged carbon steel, Hooks - Alloy Steel
FOS: 3.5:1
Heat Treatment: Quenched & tempered
Proof Load: At 200 % of WLL
Colour Code: Red



MCKAT RATCHET LOAD BINDER DIAGRAM:

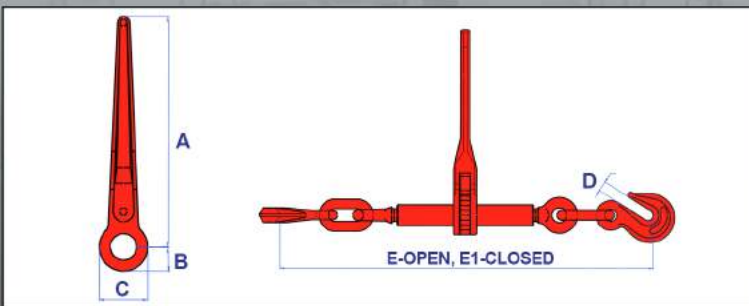

MCKAT RATCHET LOAD BINDER SPECIFICATION:

Model no.	Min - Max Chain Size (mm)	WLL (kgs)	WEIGHT (kgs)	HANDLE LENGTH (mm)	TAKE UP (mm)	DIMENSIONS (mm)					
						A	B	C	D	E	E1
MVR01	06mm	1,000	1.65	210	113	210	21	42	10	528	415
MVR02	8mm-10mm	2,400	4.70	355	164	355	32.5	65	12.7	747	583
MVR04	10mm-13mm	4,200	5.10	355	165	355	32.5	65	16.5	768	603
MVR06	13mm-16mm	6,000	7.20	355	170	355	32.5	65	18.5	860	690
MVR09	16mm-19mm	9,000	12.00	356	198	356	41	82	23.5	988	790

McKAT

BOW SHACKLE



DESCRIPTION

- ▶ Hot - dipped galvanized body.
- ▶ All Shackles are individually inspected and tested with proof load.
- ▶ Embossed forged marking for WLL, SIZE, CE and McKAT.

Standard:	BS EN 13889
Material:	Body - Forged carbon steel, Pin - Alloy Steel
FOS:	6:1
Heat Treatment:	Quenched & tempered
Proof Load:	At 200 % of WLL
Colour Code:	Body - Silver, Pin - Red



McKAT originality



Forged WLL Marking



Technical Standards Conformity

DIAGRAM:

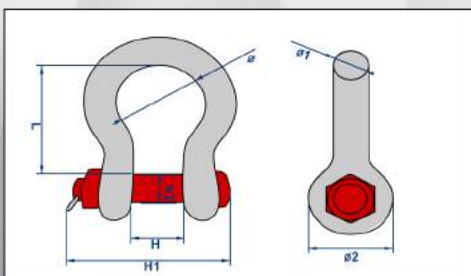

MCKAT BOW SHACKLE SPECIFICATION:

ARTICLE NO.		SIZE(mm)	WLL (T)	DIMENSIONS (mm)								NET WT. (kg)	
Screw Pin	Nut & Bolt			Ø	Ø 1	Ø 2	Ø 3	H	H1	H1	L	Screw Pin	Nut & Bolt
MSB - 101	MSB - 201	3/8"	1	26.2	10.0	25.0	11.2	17.0	51.5	56.5	36.5	0.13	0.17
MSB - 102	MSB - 202	1/2"	2	33.3	12.7	30.5	15.8	20.6	67.5	75.5	47.8	0.31	0.37
MSB - 103	MSB - 203	5/8"	3.25	43.0	16.0	40.0	18.8	27.0	85.0	92.0	60.0	0.63	0.72
MSB - 104	MSB - 204	3/4"	4.75	51.0	19.0	48.0	22.0	32.0	98.5	106.0	71.5	1.04	1.14
MSB - 106	MSB - 206	7/8"	6.5	58.0	22.0	54.0	25.0	37.0	114.0	120.0	84.5	1.53	1.73
MSB - 108	MSB - 208	1"	8.5	68.5	26.5	60.0	28.0	43.5	129.5	135.0	96.2	2.35	2.51
MSB - 109	MSB - 209	1-1/8"	9.5	75.0	29.0	68.0	32.0	48.0	144.0	143.0	109.0	3.45	3.75
MSB - 112	MSB - 212	1-1/4"	12	84.0	32.0	76.0	35.0	53.0	157.0	164.0	120.5	4.61	4.83
MSB - 113	MSB - 213	1-3/8"	13.5	94.0	35.0	84.0	38.0	59.0	171.0	182.0	134.0	6.17	7.18
MSB - 117	MSB - 217	1-1/2"	17	99.0	38.0	92.0	42.0	62.0	190.0	195.0	148.5	7.81	8.41
MSB - 125	MSB - 225	1-3/4"	25	128.0	45.0	106.0	50.0	75.0	225.0	224.0	178.0	13.1	15.4
MSB - 135	MSB - 235	2"	35	148.0	52.0	122.0	55.0	84.0	253.0	248.0	197.0	20.4	23.7
MSB - 155	MSB - 255	2-1/2"	55	186.0	66.0	145.0	70.0	107.0	318.0	302.0	269.5	40.0	44.0
MSB - 185	MSB - 285	3"	85	205.0	76.0	165.0	80.0	130.0	382.0	395.0	325.0	59.0	63.0

McKAT[®]

D SHACKLE



DESCRIPTION

- ▶ Hot - dipped galvanized body.
- ▶ All Shackles are individually inspected and tested with proof load.
- ▶ Embossed forged marking for WLL, SIZE, CE and McKAT.

Standard:	BS EN 13889
Material:	Body - Forged carbon steel, Pin - Alloy Steel
FOS:	6:1
Heat Treatment:	Quenched & tempered
Proof Load:	At 200 % of WLL
Colour Code:	Body - Silver, Pin - Red

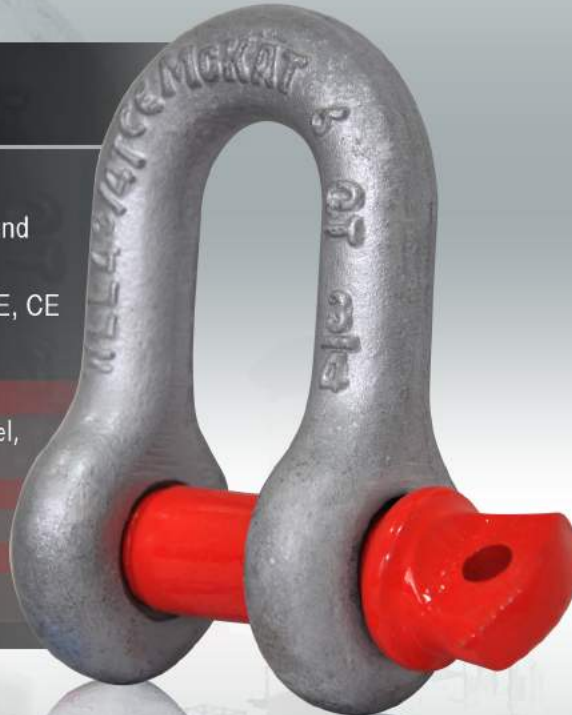
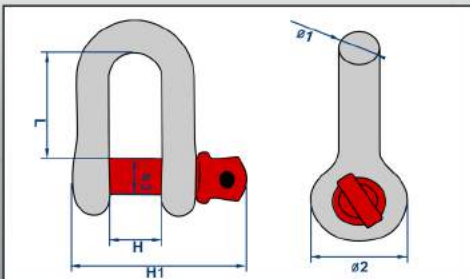

DIAGRAM:



MCKAT D SHACKLE SPECIFICATION:

ARTICLE NO.		SIZE(mm)	WLL (T)	DIMENSIONS (mm)							NET WT. (kg)	
Screw Pin	Nut & Bolt			Ø 1	Ø 2	Ø 3	H	H1	H1	L	Screw Pin	Nut & Bolt
MSD - 101	MSD - 201	3/8"	1	10.0	25.0	11.2	17.0	53.5	57.5	30.9	0.13	0.15
MSD - 102	MSD - 202	1/2"	2	12.7	31.0	15.8	20.6	70.3	74.5	41.4	0.29	0.33
MSD - 103	MSD - 203	5/8"	3.25	16.0	40.0	19.0	27.0	88.0	93.0	51.0	0.59	0.65
MSD - 104	MSD - 204	3/4"	4.75	19.0	48.0	22.0	32.0	101.0	107.0	63.0	0.99	1.08
MSD - 106	MSD - 206	7/8"	6.5	22.0	54.0	25.0	37.0	117.0	121.0	72.0	1.46	1.52
MSD - 108	MSD - 208	1"	8.5	26.5	60.0	28.0	43.5	137.0	137.0	81.7	2.07	2.52
MSD - 109	MSD - 209	1-1/8"	9.5	29.0	68.0	32.0	48.0	145.5	145.0	94.0	3.11	3.43
MSD - 112	MSD - 212	1-1/4"	12	32.0	76.0	35.0	53.0	161.0	167.0	102.0	4.11	4.93
MSD - 113	MSD - 213	1-3/8"	13.5	35.0	84.0	38.0	59.0	178.0	185.0	113.5	5.28	6.01
MSD - 117	MSD - 217	1-1/2"	17	38.0	92.0	42.0	62.0	194.5	198.0	123.0	7.24	8.40
MSD - 125	MSD - 225	1-3/4"	25	45.0	106.0	50.0	75.0	228.0	227.0	148.0	12.1	14.7
MSD - 135	MSD - 235	2"	35	52.0	122.0	56.0	84.0	255.0	250.0	174.0	19.2	21.2
MSD - 155	MSD - 255	2-1/2"	55	63.5	145.0	70.0	107.0	317.0	299.0	205.5	38.0	40.0

McKAT[®] CHAIN SLING



Endless



Single leg with self lock hook



Two leg with self lock hook



Three leg with sling hook



Four leg Lifting



Two leg Lifting

DESCRIPTION

- ▶ Slings available with capacities from 2T – 45T
- ▶ MckAT chain sling can be custom made according to the requirements with the third party inspection.
- ▶ Our In-House Service center can repair & recertify all your chain slings.

Standard: BS EN 818 - 4
FOS: 4:1
Proof Load: At 200 % of WLL

HOW TO ORDER

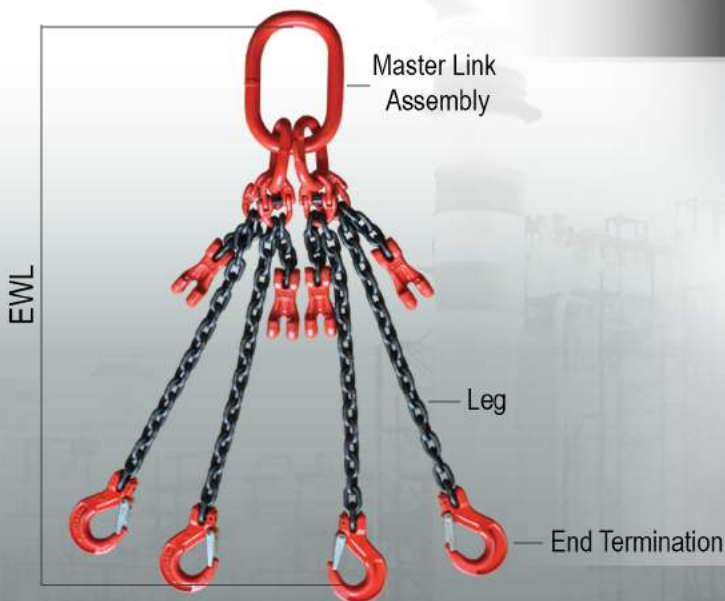

- **Chain size** Chain Diameter
- **Legs** Number of Legs
- **WLL** Working Load Limit (Ton)
- **EWL** Effective Working Length (meters)
- **Master Link or special** Master Link/ Master Link Assembly
- **End Termination** Grab Hook/ Sling Hook/ Self Lock Hook/ Shackle etc.
- **Lifting Angle** Angle from leg to vertical

MCKAT CHAIN SLING SPECIFICATION:

Chain size	Single Leg	Two Leg Angle from leg to vertical		Three/Four Leg Angle from leg to vertical	
		0 to 45	45 to 60	0 to 45	45 to 60
8 mm	2.00	2.80	2.00	4.25	3.00
10 mm	3.15	4.25	3.15	6.70	4.75
13 mm	5.30	7.50	5.30	11.20	8.00
16 mm	8.00	11.20	8.00	17.00	11.80
18 mm	10.00	14.10	10.00	21.00	15.00
20 mm	12.50	17.50	12.50	26.50	19.00
22 mm	15.00	21.20	15.00	31.50	22.40
26 mm	21.20	30.00	21.20	45.00	31.50

Working Load Limit in Tonnes

McKAT

MASTER LINK ASSEMBLY



DESCRIPTION

- Use for 3 or more legs wire rope and chain sling.
- All master link assembly are individually inspected and tested with proof load.
- Embossed forged marking for WLL, CE and McKAT

Standard: BS EN 1677
Material: Alloy Steel
FOS: 4:1
Construction: Quenched & tempered
Proof Load: At 200 % of WLL
Colour Code: Red



DIAGRAM:

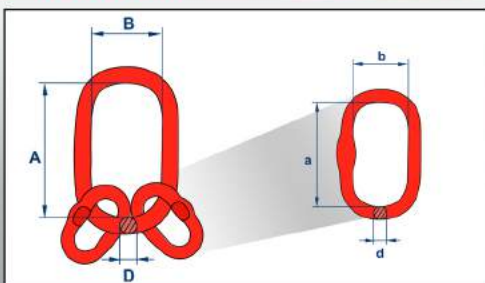

MCKAT MASTER LINK ASSEMBLY SPECIFICATION:

ARTICLE NO.	WLL (T)	A (mm)	B (mm)	D (mm)	a (mm)	b (mm)	d(mm)	NET WT. (kg)
MASTER LINK ASSEMBLY FOR CHAIN SLING								
MA-04	4.25	160	95	22	70	46	16	2.25
MA-06	6.7	200	120	30	90	60	19	4.75
MA-11.2	11.2	240	140	34	140	65	25	8.7
MA-14	14.5	200	110	28	140	70	22	5.5
MA-17	17	250	150	40	180	100	32	9.9
MA-23	23	270	140	36	185	90	28	11.9
MA-26	26.5	300	180	45	180	100	34	20.6
MA-31	31.5	380	200	50	200	100	40	30.5
MA-45	45	400	200	55	200	110	45	39
MA-67	67	430	220	60	300	180	50	67.5
MASTER LINK ASSEMBLY FOR WIRE ROPE SLING								
MA-05	5.8	170	90	20	120	70	16	2.4
MA-07	7.6	170	90	22	150	80	20	3.8
MA-08	8.5	160	90	22	140	70	20	3.6
MA-10	10	190	100	25	150	80	20	4.5
MA-11.8	11.8	270	140	28	140	70	20	5.9
MA-12	12.7	210	110	28	170	90	22	6.1
MA-15	15.2	270	140	32	190	100	25	9.5
MA-17.1	17.1	270	140	32	190	100	26	9.7
MA-22	22.3	270	150	38	230	130	30	15.3
MA-28	28.1	280	155	40	200	110	32	16.4
MA-33	33.5	340	180	45	230	130	32	21.8
MA-35	35	320	170	45	225	125	36	23.5
MA-40	40	380	200	50	270	140	38	33.2
MA-58	58	430	220	60	380	200	50	66
MA-60	60	410	250	60	350	195	50	63.9

McKAT

MASTER LINK



DESCRIPTION

- ▶ Use for 1 or 2 legs wire rope and chain sling.
- ▶ All master link are individually inspected and tested with proof load.
- ▶ Embossed forged marking for WLL, CE and McKAT

Standard: BS EN 1677
Material: Alloy Steel
FOS: 4:1
Proof Load: At 200 % of WLL
Colour Code: Red



Forged Marking



Technical standards conformity

DIAGRAM:

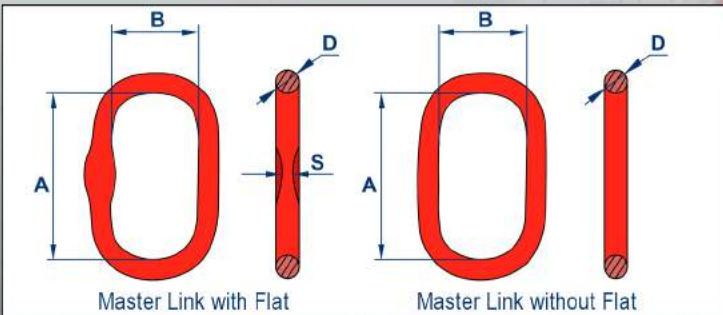

MCKAT MASTER LINK SPECIFICATION:

ARTICLE NO.	WLL (T)	A (mm)	B (mm)	D (mm)	S (mm)	NET WT. (kg)
MM-03	3.8	120	70	16	9	0.6
MM-05	5.8	170	90	20	11	1.25
MM-06	6.4	300	210	25	~	3.53
MM-10	10	190	100	25	13	2.25
MM-105	10.5	270	140	28	15	3.85
MM-11	11	300	210	32	~	5.94
MM-12	12.7	210	110	28	15	2.95
MM-15	15.2	270	140	32	17	4.9
MM-19	19	270	140	38	~	7.2
MM-21	21.2	300	180	45	~	11.7
MM-31	31.5	380	200	50	~	18.5
MM-45	45	400	200	55	~	23.5
MM-56	56	430	220	60	~	28.7
MM-70	70	450	250	70	~	42.4

McKAT[®]

G80 - CHAIN



DESCRIPTION

- ▶ High tensile steel.
- ▶ Used for making slings for lifting.
- ▶ All load chain links are individually inspected and tested.
- ▶ Embossed forged marking for chain grade and McKAT

Standard:	BS EN 818
Material:	Alloy Steel
FOS:	4:1
Heat Treatment:	Quenched & tempered
Proof Load:	At 200 % of WLL
Colour Code:	Graphite Black



DIAGRAM:

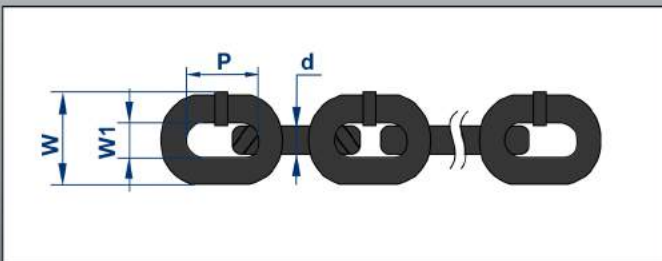

MCKAT G80 - CHAIN SPECIFICATION:

ARTICLE NO.	WLL (T)	DIA (mm)	PITCH (mm)	W1 (mm)	W (mm)	NET WT. (kg)
MCG-08	2.00	8.0	24	10.4	29.6	1.42
MCG-10	3.15	10.0	30	13	37	2.22
MCG-13	5.30	13.0	39	16.9	48.1	3.75
MCG-16	8.00	16.0	48	20.8	59.2	5.58
MCG-18	10.00	18.0	54	23.4	66.6	7.15
MCG-20	12.50	20.0	60	26	74	8.64
MCG-22	15.00	22.0	66	28.6	81.4	10.4
MCG-26	21.20	26.0	78	33.8	96.2	13.5
MCG-32	31.50	32.0	96	41.6	118	21.4



DESCRIPTION

- ▶ Use for shortening the required length of chain.
- ▶ Designed to use with grade 80 alloy steel chain.
- ▶ All shortening clutch are individually inspected and tested with proof load.
- ▶ Embossed forged marking for WLL, SIZE, CE and McKAT
- ▶ Spares are available for load pin.

Standard: BS EN 1677
Material: Alloy Steel
FOS: 4:1
Heat Treatment: Quenched & tempered
Proof Load: At 200 % of WLL
Colour Code: Red



DIAGRAM:

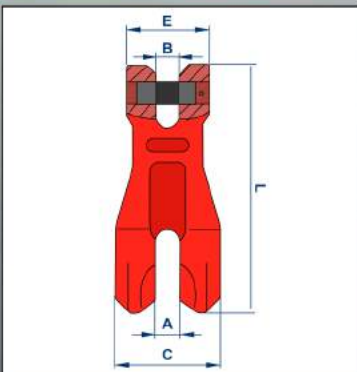

MCKAT CLEVIS CHAIN CLUTCH SPECIFICATION:

ARTICLE NO.	WLL (T)	A (mm)	B (mm)	C (mm)	E (mm)	L (mm)	NET WT. (kg)
MU-08	2	9.5	9.5	45	36	101	0.41
MU-10	3.15	13	13	55	48	138	0.97
MU-13	5.3	16	16	75	59	177	2.01
MU-16	8	21	21	93	73	220	3.32
MU-20	12.5	22	22	99	78	238	6.2
MU-22	15	25.5	25.5	118	98	295	8.5

McKAT

CONNECTING LINK



DESCRIPTION

- ▶ Use for connecting alloy steel chain to different components.
- ▶ Designed to use with grade 80 alloy steel chain.
- ▶ All connecting links are individually inspected and tested with proof load.
- ▶ Embossed forged marking for WLL, SIZE, CE and McKAT
- ▶ Spares are available for coupling pin and double - sleeve set.

Standard:	BS EN 1677
Material:	Alloy Steel
FOS:	4:1
Heat Treatment:	Quenched & tempered
Proof Load:	At 200 % of WLL
Colour Code:	Red



DIAGRAM:

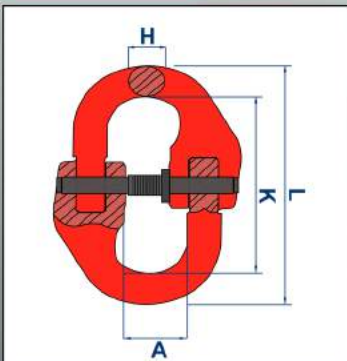

MCKAT CONNECTING LINK SPECIFICATION:

ARTICLE NO.	WLL (T)	H (mm)	A (mm)	K (mm)	L (mm)	NET WT. (kg)
MN-08	2	8.5	18	60.5	79.5	0.16
MN-10	3.15	10.8	25	68	93	0.3
MN-13	5.3	15	29	87	117	0.7
MN-16	8	19.8	34.5	108.4	148	1.1
MN-18	10	21	38	112	154	1.8
MN-20	12.5	24	41	121.5	169.5	1.9
MN-22	15	26	48	141.5	193.5	3.2
MN-26	21.2	30	57.5	158	220	4.5
MN-32	31.5	37	67	205	281	9



DESCRIPTION

- ▶ Use for connecting webbing to different components.
- ▶ All webbing connecting links are individually inspected and tested with proof load.
- ▶ Embossed forged marking for WLL, SIZE, CE and McKAT
- ▶ Spares are available for coupling pin and double - sleeve set.

Standard:	BS EN 1677
Material:	Alloy Steel
FOS:	4:1
Heat Treatment:	Quenched & tempered
Proof Load:	At 200 % of WLL
Colour Code:	Red

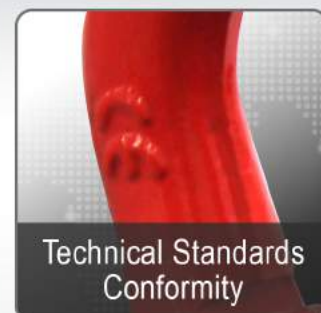
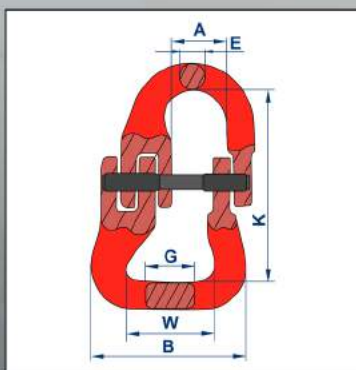

DIAGRAM:



MCKAT WEBBING CONNECTING LINK SPECIFICATION:

ARTICLE NO.	WLL (T)	A (mm)	B (mm)	K (mm)	W (mm)	G (mm)	E (mm)	NET WT. (kg)
MNw-08	2.0	20	61.5	63.7	40	24	9.5	0.3
MNw-10	3.15	24	66	83	39	30.5	11	0.68
MNw-13	5.3	28	88	93.7	55	36.8	16.5	1.47
MNw-16	8	34.5	108	120	65.5	45.2	19.8	2.3
MNw-20	12.5	41	129	138	80	51.8	23	3.3
MNw-22	15	50	191	180	126	70	26	6.89
MNw-26	21.2	58	228.4	209.5	152	86	30	10.62
MNw-32	31.5	72.5	252	279	160	91	37	18.92

McKAT

CLEVIS SLING HOOK



DESCRIPTION

- ▶ Designed to use with grade 80 alloy steel chain.
- ▶ All clevis hooks are individually inspected and tested with proof load.
- ▶ Embossed forged marking for WLL, SIZE, CE and McKAT
- ▶ Spares are available for load pin and safety latch.

Standard:	BS EN 1677
Material:	Alloy Steel
FOS:	4:1
Heat Treatment:	Quenched & tempered
Proof Load:	At 200 % of WLL
Colour Code:	Red



DIAGRAM:

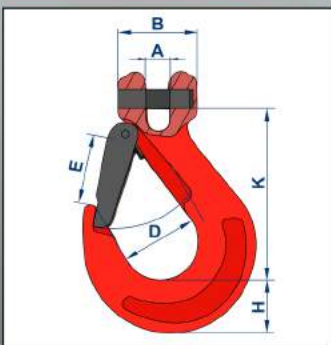

MCKAT CLEVIS SLING HOOK SPECIFICATION:

ARTICLE NO.	WLL (T)	A (mm)	B (mm)	D (mm)	H (mm)	K (mm)	E (mm)	NET WT. (kg)
MHC-08	2	9.5	37	37	32.5	85.5	29	0.52
MHC-10	3.15	13	49	46	35	104	39	1.05
MHC-13	5.3	16.5	56.5	56	42.5	128	47	2
MHC-16	8	21.5	70.5	60	54	150	55	3.7
MHC-20	12.5	24	77	79	58	180	61	6
MHC-22	15	27	91	101	62	213	72	10.4
MHC-26	21.2	30	117	115	75	250	85	14.5
MHC-32	31.5	35	150	140	88	317	106	27

McKAT

EYE - SLING HOOK



DESCRIPTION

- ▶ Designed to use for lifting slings.
- ▶ All eye - sling hook are individually inspected and tested with proof load.
- ▶ Embossed forged marking for WLL, SIZE, CE and McKAT
- ▶ Spares are available for safety latch.

Standard:	BS EN 1677
Material:	Alloy Steel
FOS:	4:1
Heat Treatment:	Quenched & tempered
Proof Load:	At 200 % of WLL
Colour Code:	Red



DIAGRAM:

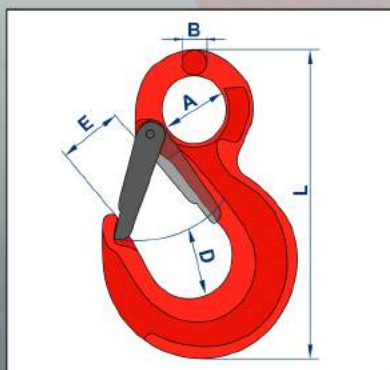

MCKAT EYE - SLING HOOK SPECIFICATION:

ARTICLE NO.	WLL (T)	A (mm)	B (mm)	D (mm)	E (mm)	L (mm)	NET WT. (kg)
MHE-08	2	25	11	26	30	133	0.4
MHE-10	3.15	38	15	39	34	167	0.9
MHE-13	5.3	43	19	54	39	213	1.7
MHE-16	8	50	23	64	46	255	3.2
MHE-20	12.5	62	24	80	40	305	5.8
MHE-22	15	62	32	80	71	348	8.5
MHE-26	21.2	64	35	82	81	394	13
MHE-32	31.5	88	37	112	102	480	17

McKAT

CLEVIS SELF LOCK HOOK



DESCRIPTION

- ▶ Designed to use with grade 80 alloy steel chain.
- ▶ All clevis self lock hook are individually inspected and tested with proof load.
- ▶ Enhance safety with positive lock latch.
- ▶ Embossed forged marking for WLL, SIZE, CE and McKAT
- ▶ Spares are available for load pin and positive lock trigger kit.

Standard:	BS EN 1677
Material:	Alloy Steel
FOS:	4:1
Heat Treatment:	Quenched & tempered
Proof Load:	At 200 % of WLL
Colour Code:	Red



DIAGRAM:

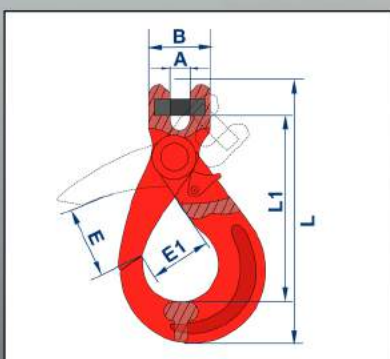

MCKAT CLEVIS SELF LOCK HOOK SPECIFICATION:

ARTICLE NO.	WLL (T)	A (mm)	B (mm)	E (mm)	E1 (mm)	L (mm)	L1 (mm)	NET WT. (kg)
MHCS-08	2	9.5	38.5	40	35.8	161	119.3	0.8
MHCS-10	3.15	12.5	46	50	45	195	142	1.38
MHCS-13	5.3	15	59	60	52.5	249	179	2.81
MHCS-16	8	18.5	77	65	63.3	310	224.8	6
MHCS-20	12.5	25	77	80	86	335	238.3	7.25
MHCS-22	15	25	97.5	83	76	392	277	12.8
MHCS-26	21.2	30	113	106	96	450	312	21.8
MHCS-32	31.5	35	150	140	135	589.6	416	49.6

McKAT

EYE - SELF LOCK HOOK



DESCRIPTION

- Designed to use for lifting slings.
- All eye - self lock hook are individually inspected and tested with proof load.
- Enhance safety with positive lock latch.
- Embossed forged marking for WLL, SIZE, CE and McKAT
- Spares are available for positive lock trigger kit.

Standard:	BS EN 1677
Material:	Alloy Steel
FOS:	4:1
Heat Treatment:	Quenched & tempered
Proof Load:	At 200 % of WLL
Colour Code:	Red



DIAGRAM:

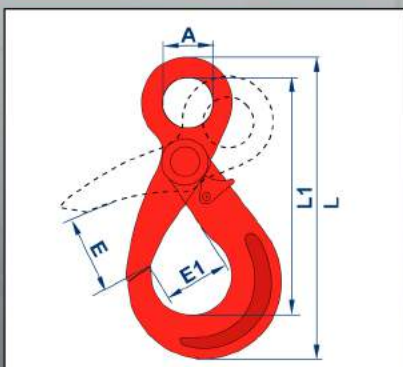

MCKAT EYE - SELF LOCK HOOK SPECIFICATION:

ARTICLE NO.	WLL (T)	A (mm)	E (mm)	E1 (mm)	L1 (mm)	L (mm)	NET WT. (kg)
MHES-08	2	25	40	35.8	136	175	0.88
MHES-10	3.15	34.5	50	45	168	214	1.58
MHES-13	5.3	40	60	52.5	207	268	3.0
MHES-16	8	50	65	63.3	254	332	5.9
MHES-20	12.5	64.5	80	86	274.5	332	7.0
MHES-22	15	70	83	76	319	415	12.3
MHES-26	21.2	80	106	96	362	472	20
MHES-32	31.5	105	140	133	470	614	44

McKAT[®]

GRAB HOOK



DESCRIPTION

- ▶ Use for shortening or holding required length of chain.
- ▶ For use with Grade 80 alloy steel chain.
- ▶ All grab hook are individually inspected and tested with proof load.
- ▶ Embossed forged marking for WLL, SIZE, CE and McKAT
- ▶ Spares are available for load pin.

Standard: BS EN 1677
Material: Alloy Steel
FOS: 4:1
Heat Treatment: Quenched & tempered
Proof Load: At 200 % of WLL
Colour Code: Red



DIAGRAM:

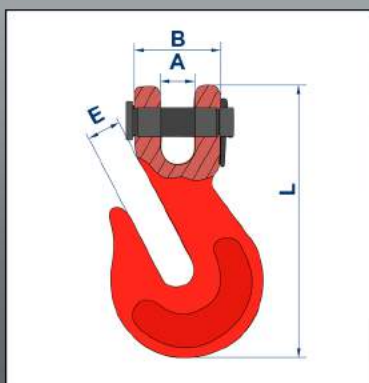

MCKAT GRAB HOOK SPECIFICATION:

ARTICLE NO.	WLL (T)	A (mm)	B (mm)	E (mm)	L (mm)	NET WT. (kg)
MHG-08	2	10	30.5	11.2	93	0.62
MHG-10	3.15	13	35	12.7	114.5	1.00
MHG-13	5.3	19	47	17	144	2.22
MHG-16	7.2	23	56	20	177	4.41

McKAT

PIPE SORTING HOOK



DESCRIPTION

- ▶ Used for lifting pipes and metal sheets.
- ▶ All pipe sorting hooks are individually inspected with proof load
- ▶ Embossed forged marking for WLL, SIZE, CE, and McKAT

Standard: BS EN 1677
Material: Alloy Steel
FOS: 4:1
Heat Treatment: Quenched & tempered
Proof Load: At 200 % of WLL
Colour Code: Red



DIAGRAM:

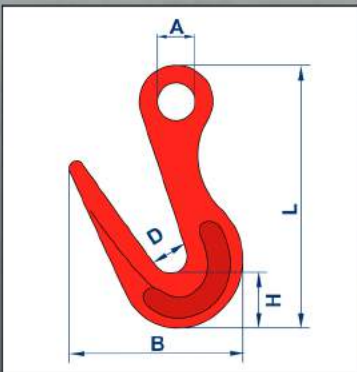

MCKAT PIPE SORTING HOOK SPECIFICATION:

ARTICLE NO.	WLL (T)	A (mm)	B (mm)	D (mm)	H (mm)	L (mm)	NET WT. (kg)
MHP-2T	2	35	170	33	49	254	3.09

McKAT[®]

CONTAINER LUGS



DESCRIPTION

- ▶ Used for lifting containers.
- ▶ All container lugs are individually inspected with proof load
- ▶ Embossed forged marking for WLL, SIZE, CE, and McKAT

Standard:	BS EN 1677
Material:	Forged Super Alloy Steel
FOS:	4:1
Heat Treatment:	Quenched & tempered
Proof Load:	At 200 % of WLL
Colour Code:	Red



DIAGRAM: STRAIGHT TYPE

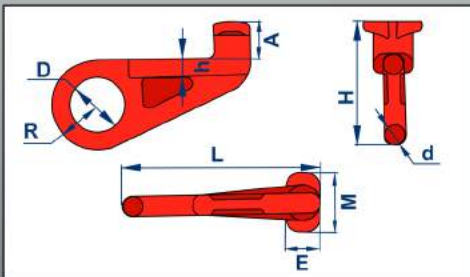

DIAGRAM: LEFT TYPE

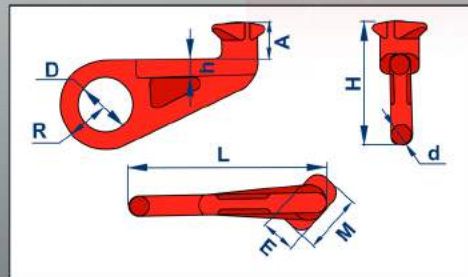
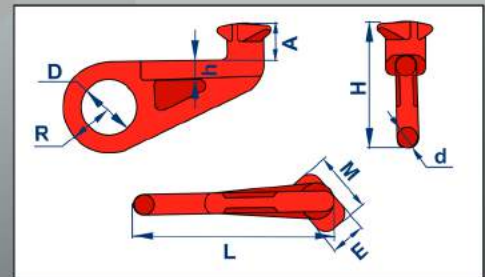

DIAGRAM: RIGHT TYPE



MCKAT CONTAINER LUGS STRAIGHT TYPE SPECIFICATION:

ARTICLE NO.	WLL (T)	A (mm)	D (mm)	d (mm)	E (mm)	H (mm)	h (mm)	L (mm)	M (mm)	R (mm)	NET WT. (kg)
MHLS	12.5	46	70	25	48	166	25	265	75	60	4

MCKAT CONTAINER LUGS LEFT TYPE SPECIFICATION:

ARTICLE NO.	WLL (T)	A (mm)	D (mm)	d (mm)	E (mm)	H (mm)	h (mm)	L (mm)	M (mm)	R (mm)	NET WT. (kg)
MHLL	12.5	46	70	25	48	166	25	265	75	60	4

MCKAT CONTAINER LUGS RIGHT TYPE SPECIFICATION:

ARTICLE NO.	WLL (T)	A (mm)	D (mm)	d (mm)	E (mm)	H (mm)	h (mm)	L (mm)	M (mm)	R (mm)	NET WT. (kg)
MHLR	12.5	46	70	25	48	166	25	265	75	60	4



DESCRIPTION

- ▶ Used for lifting container.
- ▶ All large opening container hook are individually inspected and tested with proof load.
- ▶ Embossed forged marking for WLL, CE and McKAT.

Standard:	BS EN 1677
Material:	Forged Super Alloy Steel
FOS:	4:1
Heat Treatment:	Quenched & tempered
Proof Load:	At 200 % of WLL
Colour Code:	Red



DIAGRAM:

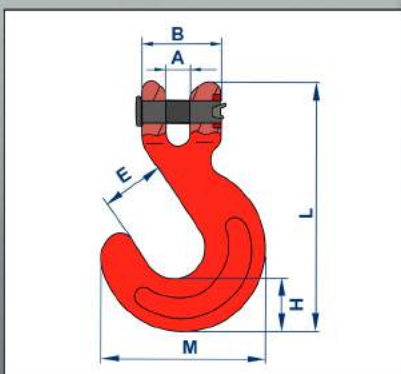

MCKAT LARGE OPENING CONTAINER HOOK SPECIFICATION:

ARTICLE NO.	WLL (T)	A (mm)	B (mm)	E (mm)	H (mm)	M (mm)	L (mm)	NET WT. (kg)
MHO-13	5	16	54.5	58.4	37	127	188	1.5

McKAT[®]

WELD ON CLAMP



DESCRIPTION

- ▶ Used as attachment to mobile lifting equipment.
- ▶ Better welding quality.
- ▶ Spares are available for forged latch.
- ▶ Embossed forged marking for WLL, CE and McKAT

Standard:	BS EN 1677
Material:	Forged Super Alloy Steel
FOS:	5:1
Heat Treatment:	Quenched & tempered
Proof Load:	200 % of WLL
Colour Code:	Red



DIAGRAM:

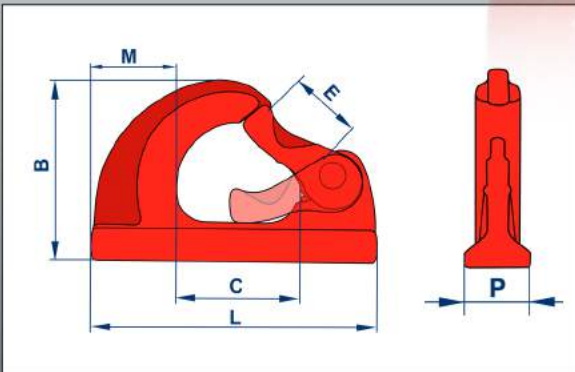

MCKAT WELD ON CLAMP SPECIFICATION:

ARTICLE NO.	WLL (T)	B (mm)	C (mm)	E (mm)	L (mm)	M (mm)	P (mm)	NET WT. (kg)
MHW-02	2	92	67	30	114	23.3	34	0.83
MHW-03	3	106	73.5	33.2	129	33.6	36	1.2
MHW-05	5	133	94	39	171	44	43.5	2.46
MHW-08	8	136.5	94	35	177	44	51	3.26
MHW-10	10	169.5	134.5	50.54	223	54.7	53	5.17

McKAT

FORGED D RING



DESCRIPTION

- ▶ Used as lifting attachment to lift machinery and equipment.
- ▶ Better welding quality.
- ▶ Embossed forged marking for WLL, SIZE and CE

Standard: BS EN 1677
Material: Alloy Steel
FOS: 4:1
Proof Load: At 200 % of WLL
Colour Code: Red



DIAGRAM:

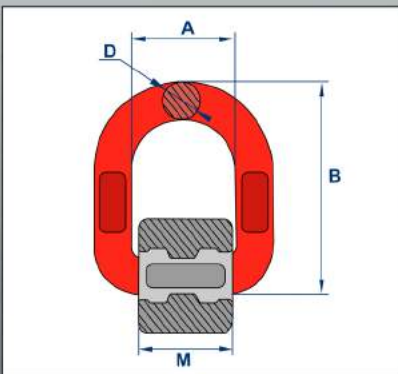

MCKAT FORGED D RING SPECIFICATION:

ARTICLE NO.	WLL (T)	A (mm)	B (mm)	D (mm)	M (mm)	NET WT. (kg)
MHD-01	1.12	41	78.5	13	37	0.4
MHD-02	2	42	88	14	40	0.47
MHD-03	3.15	45	94	17	42.5	0.69
MHD-05	5.3	55	118	22	50	1.46
MHD-08	8	70	141	26.5	66.5	2.5
MHD-15	15	97	188	34	90	5.79

MCKAT[®]

HEAVY DUTY THIMBLE



DESCRIPTION

- ▶ Material: conforms to Federal Specifications QQ - S698 - Steel, Sheet, and Strip, Low Carbon.
- ▶ Manufacturing: Thimbles are made of Hot - Rolled or Cold - Rolled Steel Process only.
- ▶ Finish: Galvanized



MckAT originality



Technical Standards Conformity

MCKAT HEAVY DUTY THIMBLE CLASSIFICATIONS:

Thimbles with below specifications meets TYPE III Thimbles for Heavy Steel Wire Ropes.

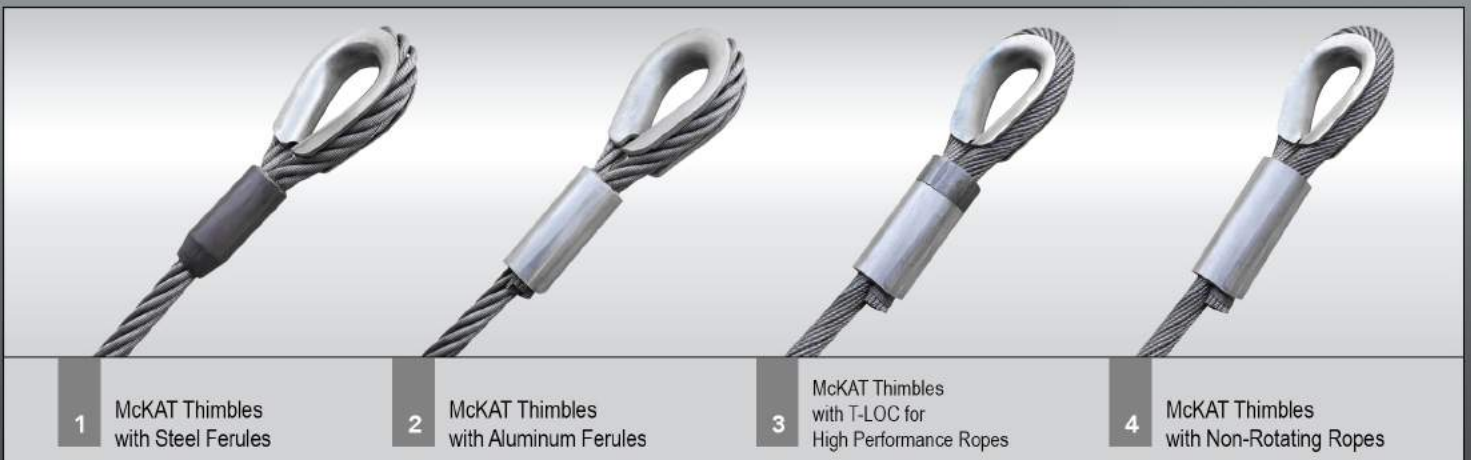

1 MckAT Thimbles with Steel Ferules

2 MckAT Thimbles with Aluminum Ferules

3 MckAT Thimbles with T-LOC for High Performance Ropes

4 MckAT Thimbles with Non-Rotating Ropes

MCKAT HEAVY DUTY THIMBLE DIAGRAM:

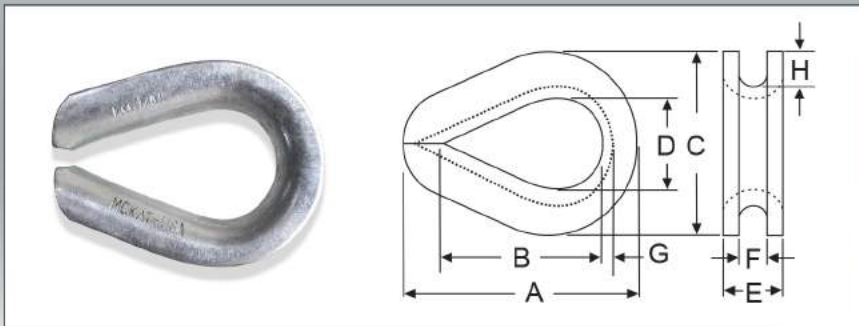

MCKAT HEAVY DUTY THIMBLE SPECIFICATIONS:

ARTICLE NO.	SIZE(in)	WT/100 PCS (KG)	A (mm)	B (mm)	C (mm)	D (mm)	E (mm)	F (mm)	G (mm)	E (mm)
01	1/8	2.80	49.53	33.53	28.92	17.78	6.35	4	1.29	3.56
02	3/16	2.80	49.53	33.53	28.92	17.78	6.35	4	1.29	3.56
03	1/4	3.06	55.62	41.40	38.1	22.35	10.41	7.11	1.52	5.84
04	5/16	5.10	63.50	47.75	45.97	26.92	12.7	8.64	2.03	7.11
05	3/8	11.34	73.5	54.10	54.10	28.70	16.00	10.41	2.79	8.64
06	7/16	13.61	82.55	60.45	60.45	31.75	18.29	11.94	3.30	9.65
07	1/2	23.13	92.20	69.85	69.85	38.10	20.57	13.46	3.56	10.41
08	9/16	23.13	92.20	69.85	68.33	38.10	22.35	15.00	3.56	10.41
09	5/8	34.02	107.95	82.55	79.50	44.45	24.64	16.76	4.06	12.70
10	3/4	66.68	127.00	92.25	99.77	50.80	31.00	19.81	5.59	16.76
11	7/8	79.38	139.70	107.95	107.95	57.15	35.05	23.88	5.59	19.05
12	1	124.74	155.70	114.30	125.48	63.50	39.62	26.92	6.35	22.35
13	1 1/8 - 1 1/4	181.44	177.80	130.30	149.35	73.15	45.97	33.27	6.35	28.70
14	1 1/4 - 1 3/8	370.59	230.12	165.1	172.97	88.90	55.63	36.58	9.65	28.70
15	1 3/8 - 1 1/2	532.98	228.60	158.75	181.10	88.90	65.02	39.62	12.70	28.70
16	1 5/8	771.12	285.75	203.20	206.50	101.60	69.09	43.67	12.70	34.03
17	1 3/4	805.14	309.63	228.60	215.90	114.30	72.14	46.74	12.70	35.07
18	1 7/8 - 2	1134.00	384.30	304.80	263.65	152.40	78.49	53.09	12.70	38.10
19	2 1/4	1791.72	435.10	355.60	301.75	177.80	92.20	60.45	16.00	41.40
20	2 3/8	2220.00	457.40	377.90	301.75	177.80	95.92	63.92	16.00	43.00
21	2 1/2	2850.00	522.00	399.10	316.20	187.80	102.60	66.60	16.00	45.50
22	2 3/4	3012.00	496.20	418.20	320.00	187.80	109.65	73.65	18.20	47.90
23	2 7/8	3600.00	522.00	443.00	330.00	196.00	116.00	76.00	19.88	50.83
24	3	3850	540.00	465.00	330.00	196.00	120.00	80.00	19.88	51.64
25	3 1/2	4400	660.00	505.00	380.00	240.00	139.00	95.00	21.88	54.60

McKAT[®]

BARREL HOOK



DESCRIPTION

- ▶ Used for lifting metal drum/barrel.
- ▶ All barrel hooks are individually inspected with proof load
- ▶ Embossed forged marking for WLL, SIZE, CE, and McKAT

Standard:	BS EN 1677
Material:	Alloy Steel
FOS:	4:1
Heat Treatment:	Quenched & tempered
Proof Load:	At 200 % of WLL
Colour Code:	Red



DIAGRAM:

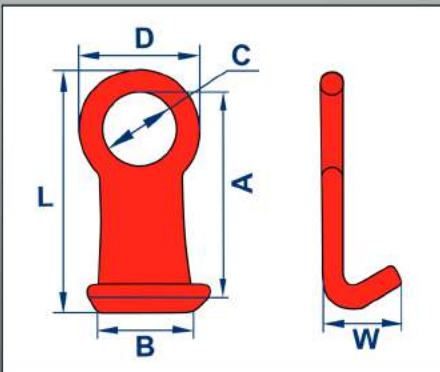

MCKAT BARREL HOOK SPECIFICATION:

ARTICLE NO.	WLL (T)	A (mm)	B (mm)	C (mm)	D (mm)	L (mm)	W (mm)	NET WT. (kg)
MHB-01	1	109	60	38	71	118.5	59	0.7
MHB-02	2	102	50	40	66	128	43	0.55

DO'S

- ▶ Do check the condition of the slings before each load.
- ▶ Do check the chain legs are not twisted.
- ▶ Do check that the load is on the centre of the hook and not the tip.
- ▶ Do ensure McKat chain slings are used by trained personnel as improper use could lead to personal injury and damage to property.

DON'Ts

- ▶ Don't use the sling over the maximum working load limit.
- ▶ Don't load with the convergence angle over 120°.
- ▶ Don't shock load in either a slight, medium or strong way.
- ▶ Don't submit the chains to heat treatment.
- ▶ Don't utilise the chains and accessories outside the temperature range - 40° and 200° C.

USER INFORMATION

- ▶ The loading used by McKat chain slings are determined on the basis that the item used in a symmetrical format in a multi leg sling.
- ▶ McKat chain slings should not be used in hazardous conditions which would include offshore applications, the lifting of people or dangerous loads such as liquid metals, nuclear, corrosive or caustic substances and materials.
- ▶ If any asymmetrical lift is required of McKat chain sling, it should be referred back to the supplier to establish a safe lift procedure.
- ▶ If a McKat Chain Sling is being used against sharp edges or corners, the W.L.L will be affected and should be referred to the supplier to establish a safe lift load limit.
- ▶ McKat chain slings and accessories can be used for general lifting purposes covering a wide range of designs, loads, slings and follows the uniform method of rating as standard.
- ▶ Chain Slings should be used by trained personnel and it is important users act responsibly when using the equipment.

BEFORE USING ANY PIECE OF LIFTING EQUIPMENT FOR THE FIRST TIME

- ▶ Ensure that a chain sling corresponds exactly to the order and that a certificate of conformity has been supplied.
- ▶ Ensure that the marking and capacity on the chain sling corresponds to the information given on the certificate of conformity.
- ▶ Ensure that any particulars of a chain sling are entered into a register of lifting equipment.
- ▶ Ensure that safe use instructions have been supplied and read by personnel.



MCKAT  TM

Lifting Beyond Boundaries

139, Fulton Street, Suite 902, New York, NY - 10038

T : (212) 571 - 1770. **F**: (212) 571 - 1771

E : sales@mckat.us

www.mckat.us