



WEBBING CONNECTING LINK



DESCRIPTION

- Use for connecting webbing to different components.
- All webbing connecting links are individually inspected and tested with proof load.
- Embossed forged marking for WLL, SIZE, CE and McKAT
- Spares are available for coupling pin and double - sleeve set.

Standard:	BS EN 1677
Material:	Alloy Steel
FOS:	4:1
Heat Treatment:	Quenched & tempered
Proof Load:	At 200 % of WLL
Colour Code:	Red



Forged WLL Marking

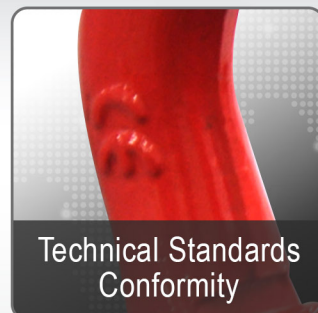

Technical Standards
Conformity

DIAGRAM:

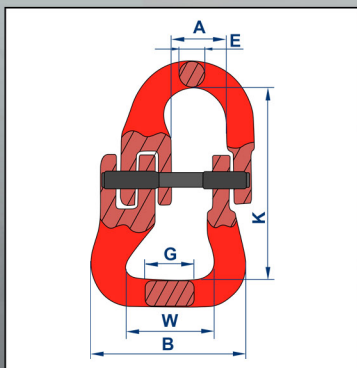

MCKAT WEBBING CONNECTING LINK SPECIFICATION:

ARTICLE NO.	WLL (T)	A (mm)	B (mm)	K (mm)	W (mm)	G (mm)	E (mm)	NET WT. (kg)
MNw-08	2.0	20	61.5	63.7	40	24	9.5	0.3
MNw-10	3.15	24	66	83	39	30.5	11	0.68
MNw-13	5.3	28	88	93.7	55	36.8	16.5	1.47
MNw-16	8	34.5	108	120	65.5	45.2	19.8	2.3
MNw-20	12.5	41	129	138	80	51.8	23	3.3
MNw-22	15	50	191	180	126	70	26	6.89
MNw-26	21.2	58	228.4	209.5	152	86	30	10.62
MNw-32	31.5	72.5	252	279	160	91	37	18.92